

## SIoux™ VACUUM TESTER

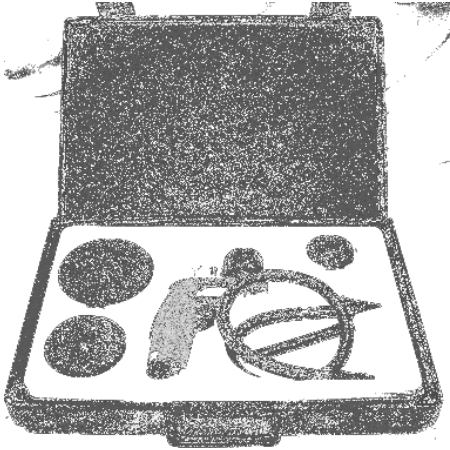

### Part No. SX1630ESK

An economical, high quality vacuum tester to check your entire valve train— valve, seat, stem and guide— quickly and accurately.

#### Kit Consists of:

SX1630	Vacuum tester
SX1630-2	2" Disc
SX1630-3	3" Disc
SX1630-4	4" Disc
SX1630B	Hose
SX1630C	Spark Plug Adapter

## O-Ring Wire

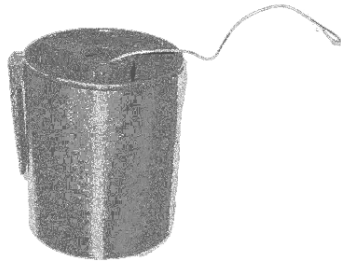

### LW7041

.042" STAINLESS STEEL WIRE—  
1LB ROLL

## TMT TAP, MACHINE AND TOOL LUBRICANT



#### BENEFITS OF USING TMT:

- IMPROVES LIFE OF REAMERS, TAPS, CUTTERS, ETC.
- PENETRATES EVEN THRU. RUST
- REMOVES RUST
- PREVENTS CORROSION
- LEAVES A DRY, DUST REPELLING SURFACE.

1-1/4 OZ BOTTLE: SL30111



## GLASS BEAD GLOVES

Replacement gloves for glass bead machines . Overall length of glove and integral gauntlet is 30" permitting use in largest machines. Extra heavy—duty, cloth lined, neoprene glove provides very long life.

For machines with up to 8" glove ports

PART NO.	DESCRIPTION
REKG	Pair of Gloves
REKGR	Right Hand Glove
REKGL	Left Hand Glove

For machines with 10" glove ports

PART NO.	DESCRIPTION
REKG-KW	Pair of Gloves
REKG-KW-R	Right Hand Glove
REKG-KW-L	Left Hand Glove

# HOT TANK GLOVES

These gloves are alkaline and oil resistant. Made from poly-vinyl chloride. Knitted cotton liner will not peel, and is fully washable. 6" gauntlet protects wrist and forearm. Exclusive, coarse rubber finish minimizes slipping when handling wet or oily parts.



PART NO. REGHT

## WIRE BRUSHES

We carry a wide range of wire wheel brushes, cup brushes, and end brushes. Refer to your Brush Research catalogue or call us for more information

## CARBON REMOVAL BRUSH



PART NO: RECBS-500

DIA.	WIRE	SHANK	O.A.L.	RPM
1/2"	.014	1/4"	6-1/4"	600

# Self-Tapping Thread Repair Inserts

### AVAILABLE SIZES

INTERNAL THREAD	CATALOG NUMBER	DRILL SIZE	PER PKG	TYPE
6-32	40382	#6	50	COARSE
8-40	40384	#8	50	FINE
M4x0.7	40120	"A"	50	METRIC
8-32	40125	"A"	50	COARSE
9-36	40136	"A"	50	FINE
M6x1.0	40140	9/32"	50	METRIC
10-32	40148	9/32"	50	COARSE
10-32	40187	9/32"	50	FINE
M6x1.0	40236	9/16"	40	METRIC
1/4-20	40250	9/16"	40	COARSE
1/4-28	40278	9/16"	40	FINE
5/16-18	40312	3/8"	25	COARSE
5/16-24	40324	3/8"	25	FINE
M8x1.25	40325	3/8"	25	METRIC
M8x1.25	40354	15/32"	20	METRIC
3/8-16	40375	15/32"	20	COARSE
3/8-24	40379	15/32"	20	FINE
M10x1.25	40390	9/16"	15	METRIC
M10x1.5	40393	9/16"	15	METRIC
M10x1.75	40399	9/16"	15	METRIC
M11x1.5	40433	9/16"	15	METRIC
7/16-14	40437	9/16"	15	COARSE
7/16-20	40457	9/16"	15	FINE
M12x1.75	40472	5/8"	10	METRIC
1/2-13	40500	5/8"	10	COARSE
1/2-20	40520	5/8"	10	FINE
9/16-12	40582	11/16"	10	COARSE
5/8-11	40625	7/8"	10	COARSE

ADDITIONAL SIZES AVAILABLE ON REQUEST

This cutaway view shows how SEAL-LOCK Self Tapping Thread Repair Inserts work. The exclusive tapping slots located on the pilot end of the insert, tap their way through the base metal and provide cuttings relief as well. As the outside threads of the insert become engaged, the displacement of base metal develops a frictional build-up. This results in a positive frictional lock between the insert and the base metal.

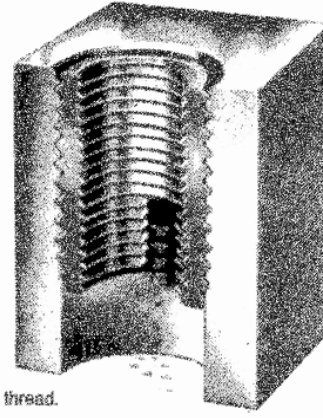

The internal threads of the insert are provided in a variety of standard thread sizes, thus permitting the replacement of virtually any size thread.

Standard Assortment Package Catalog No. 400	Metric Assortment Package Catalog No. 500	Large Thread Assortment Package Catalog No. 600
Contains 5 each:	Contains 5 each:	Contains 5 each:
1/4-20    3/8-16	M6x1.0    M8x1.25	1/2-13    M12x1.75
5/16-18    7/16-14	M10x1.5	1/2-20    9/16-12

## INSTALLATION is FAST and EASY!

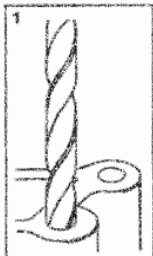

Drill out old threads with recommended drill size for the insert you are using. Drill slightly beyond the length of the insert.

**CAUTION**  
If drill bit is undersized, insert will bind.  
If drill bit is oversized, insert will be loose.

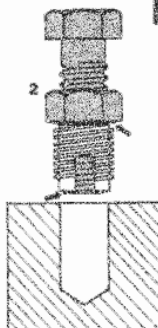

Insert bolt and nut of matching inside thread into the unslotted end of the insert.

(A Grade 5 or better nut and bolt is recommended.) Bolt should extend beyond slot. Tighten nut against insert.

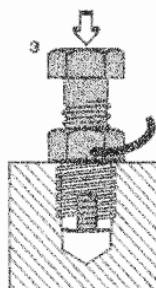

Make sure that insert is started straight by putting downward pressure on the bolt. Thread insert into hole by turning the **NUT** with an open end wrench. **DO NOT INSTALL THE INSERT BY TURNING THE BOLT.**

Do not install with impact wrench or power tools.

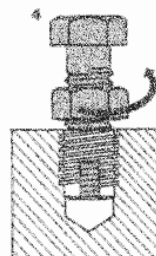

Insert is fully installed when the nut is bottomed against the repair. Break nut loose while holding bolt still with a wrench. **DO NOT TURN BOLT.**

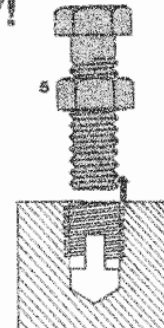

Remove nut and bolt from insert. Repair is complete.

# SELF-TAPPING SPARK PLUG THREAD REPAIR

- **Permanent** (Won't Back Out)
- **Leak Proof**
- **Easy to Use**
- **Low Cost**

Unlike ordinary helically coiled inserts, these inserts are **solid bushings**. Consequently, they always provide a precision fit for spark plug threads and can never leak compression or fluids. Once installed, the tapping holes trap cuttings and positively lock the insert in place.

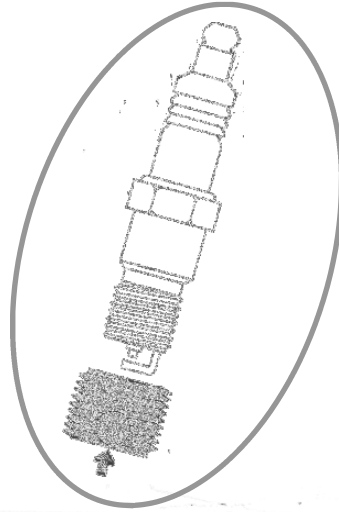

## SPK-14 KIT FOR M14 x 1.25 PORTS

- Contains:
- 1 each - M14 INSERT DRIVER
  - 1 each - M14 PILOTED REAMER
  - 1 each - M14 PILOT
  - 3 each - 3/8" REACH INSERTS
  - 3 each - 1/2" REACH INSERTS
  - 3 each - 3/4" REACH INSERTS
  - 1 each - TMT LUBE (1-1/4 OZ)
  - Complete Instructions



## SPK-12 KIT FOR M12 x 1.25 PORTS

- Contains:
- 1 each - M12 INSERT DRIVER
  - 1 each - M12 PILOT
  - 3 each - 3/4" REACH INSERTS
  - 1 each - TMT LUBE (1-1/4 OZ)
  - Complete Instructions

## SPK-18 KIT FOR M18 x 1.50 PORTS

- Contains:
- 1 each - M18 INSERT DRIVER
  - 1 each - M18 PILOT
  - 3 each - 1/2" REACH INSERTS
  - 1 each - TMT LUBE (1-1/4 OZ)
  - Complets Instructions

### REORDER PACKAGING:

CAT NO.	DESCRIPTION	PKG'G	CAT NO.	DESCRIPTION	PKG'G
12001	M12 INSERT DRIVER	1	14500	M14 x 1/2" REACH INSERT	10
12003	M12 PILOT	1	14750	M14 x 3/4" REACH INSERT	10
12750	M12 x 3/4" REACH INSERT	10	14750H	M14 x 3/4" REACH INSERT (1/2 THRD)	5
14001	M14 INSERT DRIVER	1	18001	M18 INSERT DRIVER	1
14002	M14 PILOTED REAMER	1	18003	M18 PILOT	1
14003	M14 PILOT	1	18500	M18 x 1/2" REACH INSERT	10
14375	M14 x 3/8" REACH INSERT	10	30111	TMT LUBRICANT (1-1/4 OZ BOTTLE)	1